

FloorStak[®]

Products Guide

Innovative products for Temporary
Structure installation

Support and
Levelling



Balustrade



Cassette Floor



Compact
Floor

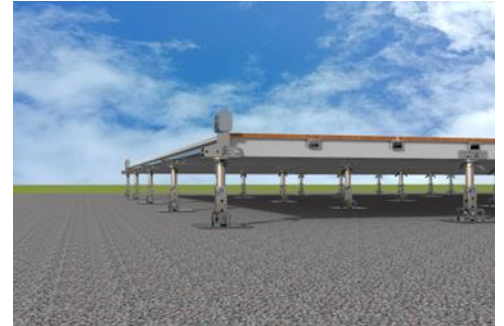

Ramps, Modular Steps
& Walkways



Bespoke
Solutions

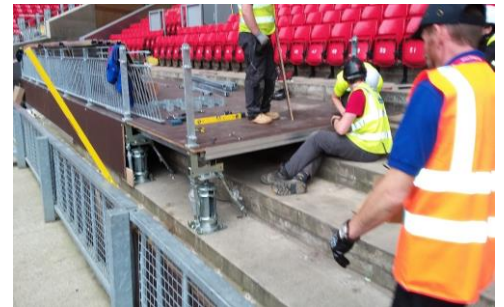

Support and Levelling



Supports and levels on uneven and sloping ground.

Maximum - Height 2 metres

Static Loading – Suitable for floor ratings up to 750Kg/m²

Rapid installation and Knock-down

Fully Integrates with structure and flooring

Verified Structural Calculations – TÜV

Minimises transport costs





Strong welded Aluminium construction satisfies regulations

Available with Reinforced Glass, Perspex, or Vertical Rail infill – also customised options for logos and branding



Integrates with FloorStak support and levelling and all flooring systems

Can be free standing or fixed between Structure Legs



Adaptable to any make, model or size of structure

Static Load rating up to 500Kg/m²

Fast Installation using Peg and Hole locations with supporting beams

Variety of finishes available, including,

- Birch-faced Plywood
- Phenolic coated anti-slip Plywood
- Decking boards for exterior situations

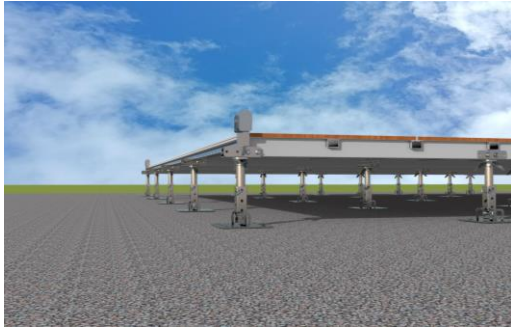

The quality of a Cassette Floor, but less than half the storage and shipping volume

Easy and quick to install

Lightweight components – great for “hard to access” locations

Can be used with i-Staks only - at heights up to 60cm

Works with all tent makes and types

Can be supplied in a variety of panel size options and surface finishes

FloorStak quality – “built-in”

Ramps, Modular Steps, Walkways



Available as individual products or combined system as shown

Modular design accommodates wide range of heights and slopes

Very fast installation and completely reusable

Packs into compact purpose-made pallets for storage and transport



In addition to the standard product range, FloorStak provide bespoke engineering for the temporary structures market. This can be,

- ❑ Make to print – for customer designs already established and proven.
- ❑ Collaborative projects – where we work closely with our customer's Design and Engineering departments.
- ❑ Design, prove and manufacture – a complete service from initial concept to final product realisation and implementation.

Technical Details

FloorStak support and levelling system – shown as configured for integration with Regent Cassette Flooring

Specifications

Materials, Construction, Finish

Low Carbon Steel Grade S235/S275

Welding to EN 1090

Hot Dip Galvanised to BS EN ISO 1461

Bright Zinc Electroplating & Thick film

blue passivation to BS EN ISO

2081:2008 Fe/Zn8/A

Applications and Load Ratings

The system can be adapted for use with all popular makes of temporary structures and flooring systems, including Cassette type floors, Heavy Duty floors and Wooden floorboards with steel sub-structures.

Overall floor load ratings are usually limited by the floor design and construction, and is typically in the range 350 kgs/m² to 500 Kgs/m². Higher load ratings can easily be achieved by the inclusion of additional Intermediate Supports.

Static and dynamic structure loading calculations are affected by the structure size, type and the geographical location of the installation. Our technical department can give advice and guidance on this subject.

www.floorstak.com

info@floorstak.com

FloorStak is a registered brand name of The Regent Engineering Co (Walsall) Ltd | Salisbury St | Darlaston | WS10 8XB | UK

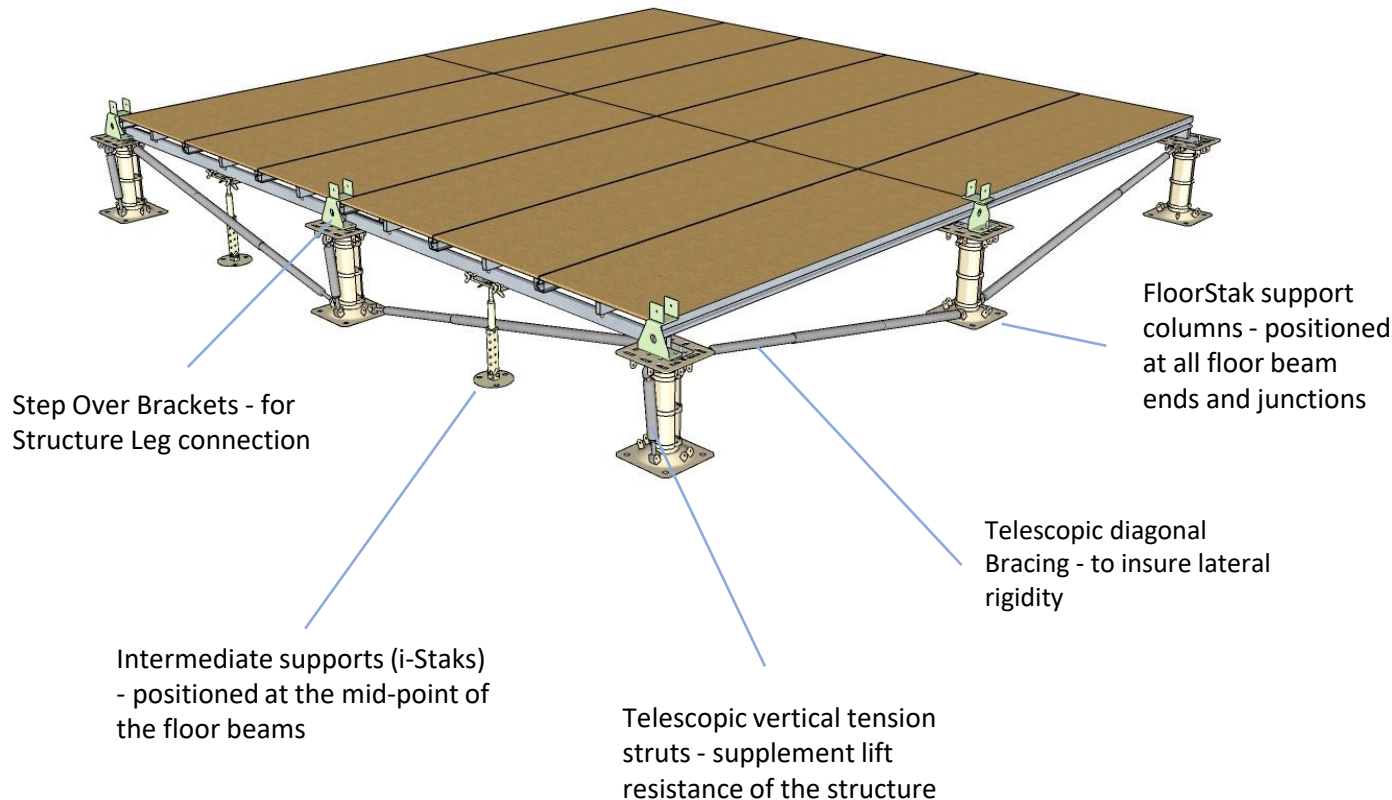

Benefits

- Universal - fits both 3m structures and 5m structures and connects to structure frames or free standing posts
- Adjustable - Unique sliding connector allows for small variations in post and frame sizes
- Can be supplied with glass (10mm toughened), solid panel, decorative, or vertical bar infill
- Quick and easy to install with a single spanner

Height to handrail	1.1m
Resistance rating – at Top handrail	Up to 1.5 Kn/M2
Resistance rating – at infill	Subject to test
Construction	Welded Aluminium Profiles
Finish	Powder Coated
Width adjustment – 2.5m Nom (5 metre bays)	Min 2390mm – Max 2506mm
Width adjustment – 3m Nom (3 metre bays)	Min 2818mm – Max 2934mm
Assembly and Adjustment	M10 spanner (supplied)

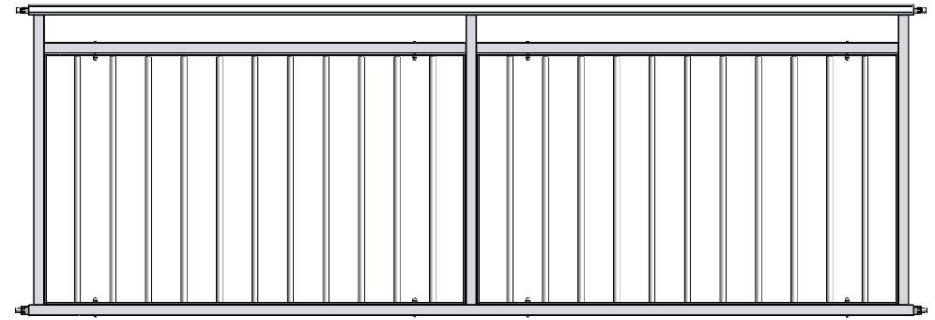
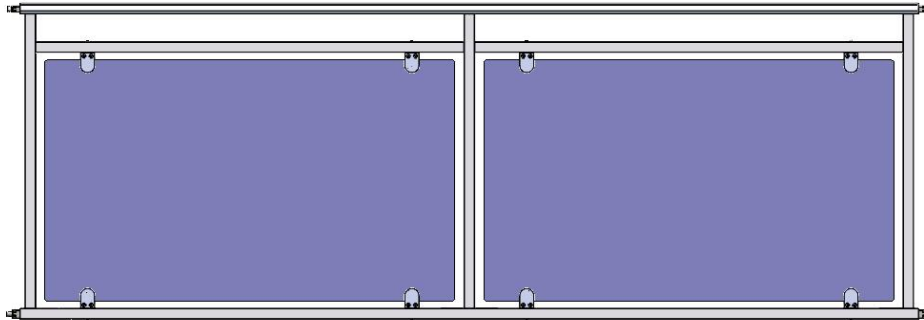

Technical Details

Regent Cassette Flooring System

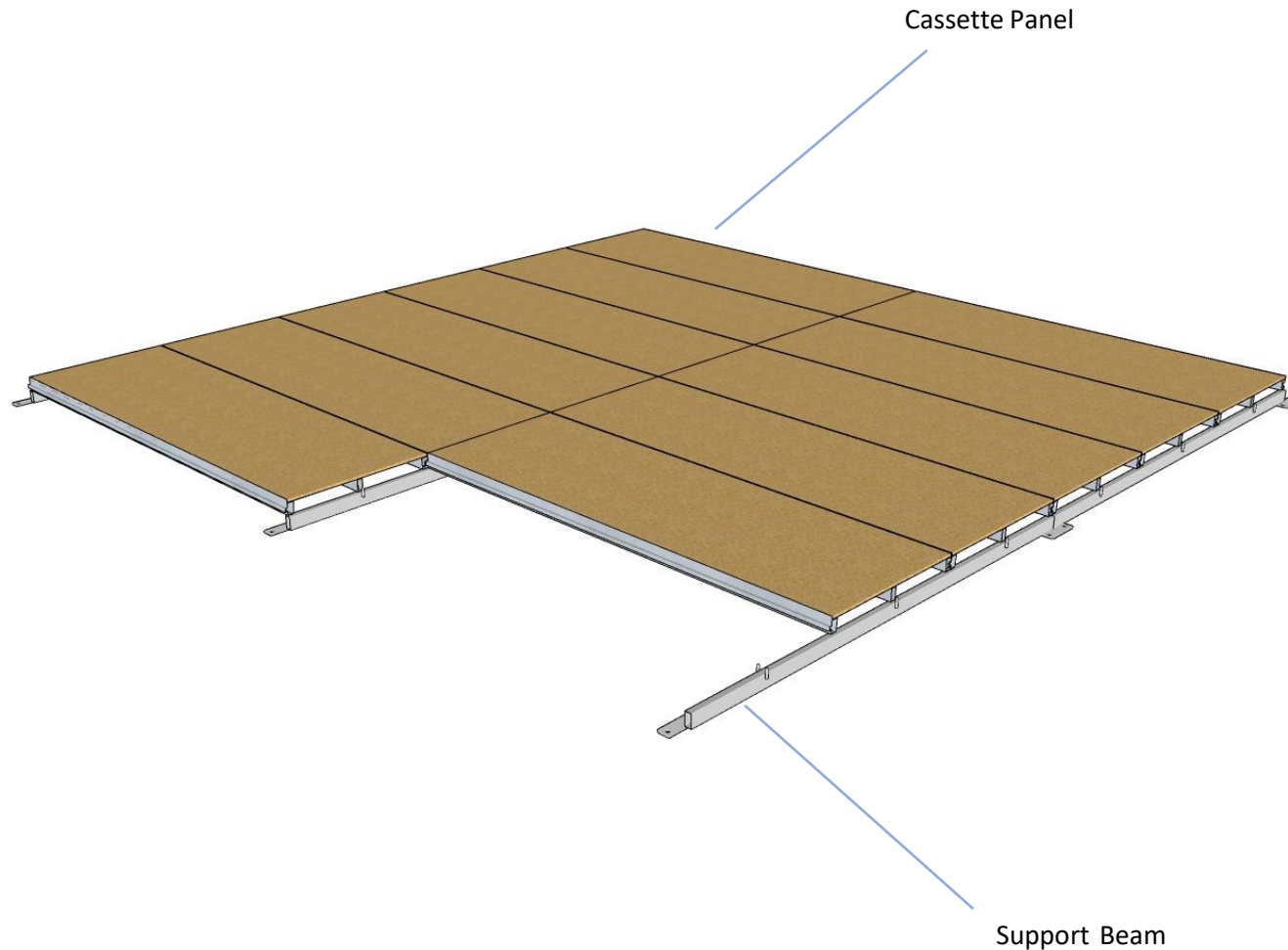

Specifications

Materials, Construction, Finish

Cassette Panels :
18mm Baltic Birch Plywood Grade B/BB,
optionally phenolic coated for weatherproofing
and anti-slip
Aluminium Grade 6082-T6
Low Carbon Steel Grade S235/S275

Support beams :

Low Carbon Steel Grade S235/S275
Welding to EN 1090
Hot Dip Galvanised to BS EN ISO 1461

Applications and Load Ratings

Suitable for use with temporary structures such
as Tents, Marquees, Walkways, Platforms,
Ramps, Landings etc.

Panel sizes and Beam lengths optimized to suit
structure parameters.

Static Loadings range from 350 Kgs/m² to 500
Kgs/m² depending on configuration and
support arrangement.

www.floorstak.com info@floorstak.com

FloorStak is a registered brand name of The
Regent Engineering Co (Walsall) Ltd | Salisbury St
| Darlaston | WS10 8XB | UK

Technical Details

Compact Flooring System

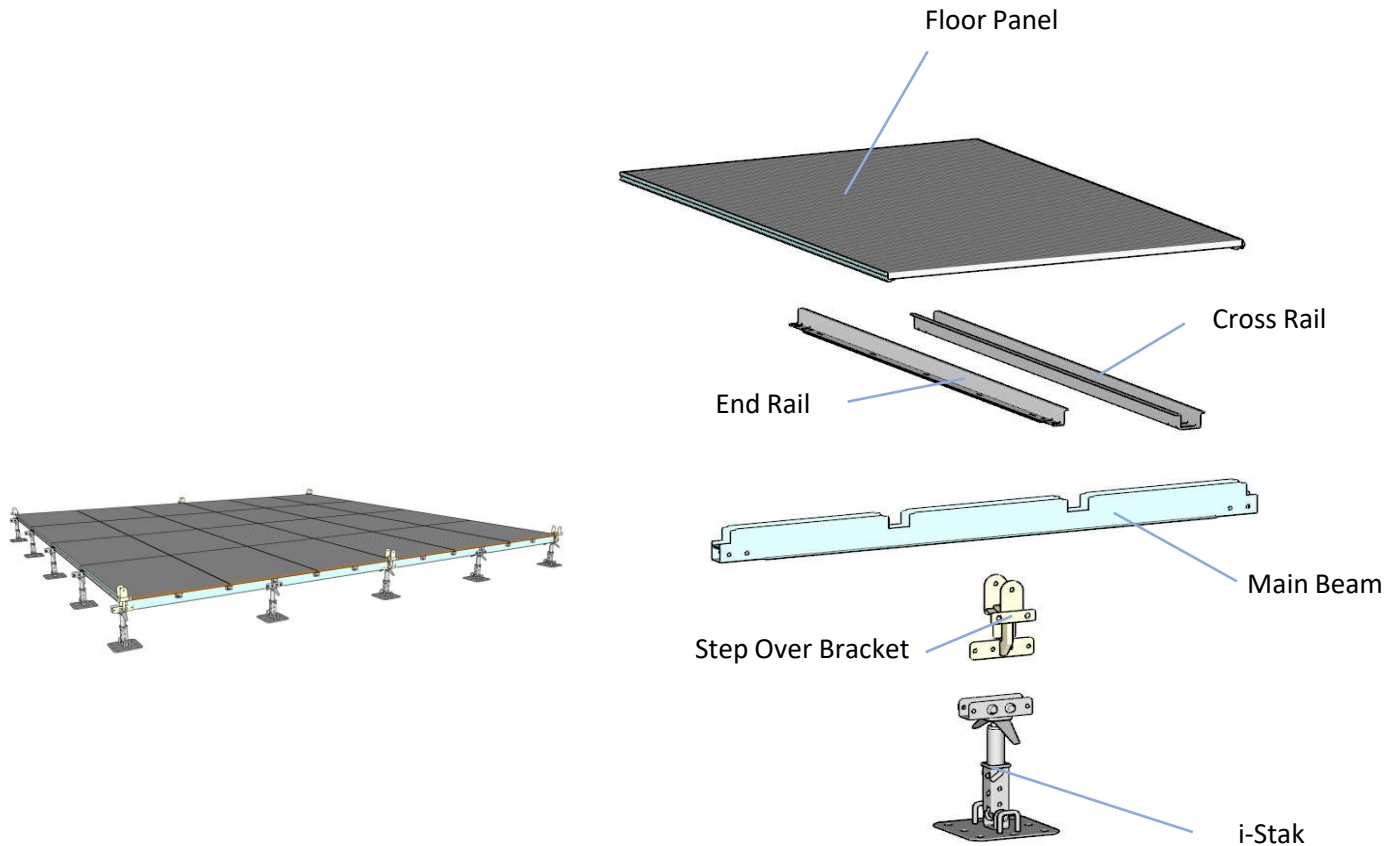

Specifications

Materials, Construction, Finish

Floor Panels :
18mm Baltic Birch Plywood Grade B/BB,
optionally phenolic coated for weatherproofing
and anti-slip
Aluminium Grade 6082-T6

End Rails & Cross Rails :
Carbon Steel Grade S355

Support beams :
Aluminium Grade 6061-T6

i-Staks & Step Over Brackets :
Carbon Steel Grades S235 to S275

Welding : EN 1090

Hot Dip Galvanised : BS EN ISO 1461

Electroplating : BZP & Thick Film Passivate to
FEZB8 2A-HB

Benefits

- Superbly versatile – simply add modules as required by floor height
- Quick and easy to assemble with one spanner or impact driver
- Uses standard iStak supports for ultimate adjustability even on the most undulating sites
- Identical modular step units - no design input required, no skilled tradesperson required
- Universal “landing” element means units can be assembled in straight, 90 Degree turn, or 180 Degree turn configurations
- Satisfies regulatory requirements

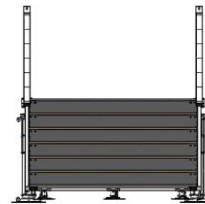
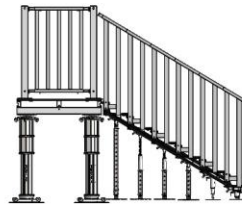
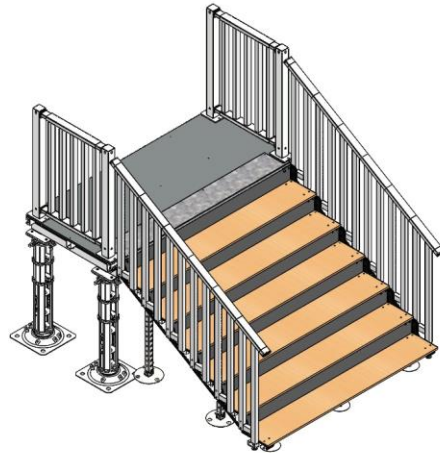

Maximum Load per step	190 Kgs (safety margin 1.5X)
Standard Step width	120cm (other sizes made to order)
Standard Height per step (Rise)	17cm
Standard Depth per step (Go)	30cm

Construction - Steps	Steel Brackets and support spines, with Phenolic coated anti-slip treads, Aluminium nosings.
Construction - Handrails	Powder coated aluminium profiles with steel connector brackets.

Assembly	Bolts together with M10 Hex Head bolts (supplied) One spanner required (supplied). 2 x standard iStak units required under each alternate step.
----------	---

Benefits

- Satisfies UK Building Regulations Part M: Access and facilities for disabled people.
- Infinitely adjustable for heights up to 2 Metres.
- Straight, offset, 90°, or U-turn configurations.
- Quick and easy to install with no special tools.
- Utilises standard FloorStak support elements, so can be installed on sloping or uneven ground.
- Can be customised to work with any make of cassette floor system.
- A variety of handrail designs available.
- Attractively designed and finished to give a professional impression

Gradient Options	1 in 12 to 1 in 20
Width	Various options to comply with regulations
Deck Material	18mm Birch Ply with Phenolic Anti-Slip and weather-resistant finish.

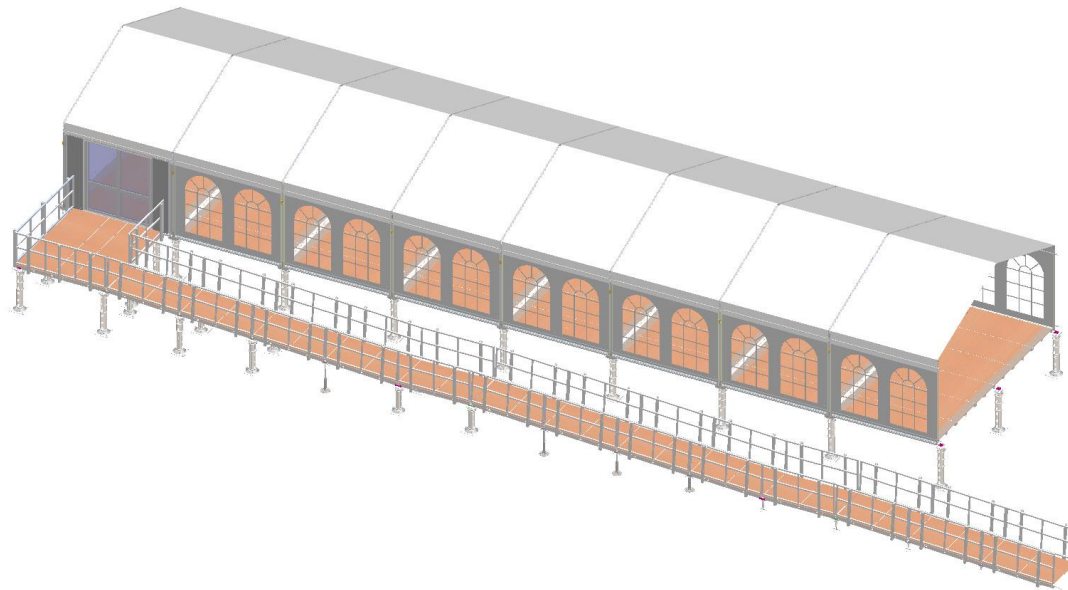

www.floorstak.com info@floorstak.com

FloorStak is a registered brand name of The
Regent Engineering Co (Walsall) Ltd | Salisbury St
| Darlaston | WS10 8XB | UK

The FloorStak® support and levelling system has passed the examination criteria for TÜV certification.



Testing Office for the Stability of Temporary Structures. Examination Report No: 3300-7148-2015 B eng. (Germany)

FloorStak® support and levelling systems, plus the associated Flooring, Sub-Floor, Access and Balustrading products have been designed to comply with the following standards and industry guidelines,

BS EN 13782:2015 Temporary structure. Tents. Safety

BS EN 13814:2004 Fairground and amusement park machinery and structures. Safety

The Institution of Structural Engineers - Temporary demountable structures: Guidance on procurement, design and use (Fourth edition) 2017

Regent Engineering is an ISO 9001 : 2015 registered Company. Certificate No FM 11560

Patent No EP 2 434 071 applies on certain products.

UK

Regent Eng Co Ltd
Darlaston UK
WS10 8XB
+44 121 526 6060
info@regenteng.com
www.floorstak.com

Germany

Marc Bartschat
D-58809 Neuenrade
Germany
+49 151 6144 0793
marcbartschat@floorstak.de
www.floorstak.de

Benelux

Tentconcepts EU
Didier Heylen
Kromvendreef 79,
2900 Schoten,
Belgium
+32 475 39 38 00
didierheylen@tentconcepts.com
www.tentconcepts.com

Australia

HTS tentiQ GmbH
15 Ketch Close,
Fountaindale,
NSW 2258
Australia
+61 (0) 2 4388 3076
jeff.stevens@hts-tentiq.com
www.hts-tentiq.com

South Asia

ClearSpan Structures India Pvt Ltd
22nd Floor, West Gate Building,
SG Highway, Ahmedabad – 380015
Gujarat
Mobile: [+91-9672981168](tel:+91-9672981168)
Landline: +91-79-66118431
Email:
rohit.sharma@clearspanindia.com
www.clearspanindia.com